

SCREENING -
SIEVING



ENVIORAK

BAR SCREEN

INCLINED SCREENS
FOR CHANNELS
FINE OR COARSE SCREENING

 Enviroscreens

DESCRIPTION / OPERATION

Envirorak inclined screens, RKS series, are installed in channels. They fulfill both fine or coarse screening function. They can also be equipped with a fully integrated compactor for screenings dewatering (RKS/P series).

The effluent passes through the screen, while the waste is stopped by vertical bars spaced apart according to the desired mesh.

The screen start-up is programmed periodically, and by loss of head measurement caused by the accumulation of waste on the bars.

The waste is lifted by means of multiple rakes driven by two lateral chains.

SPECIFICITIES

- Installation : Chanel
- 75° inclined bar screen
- Bar spacing from 3 to 60 mm
- Discharge height up to 8 m
- Screenings discharge downstream
- Rake driving by lateral chains
- Simple design, reliable and sturdy

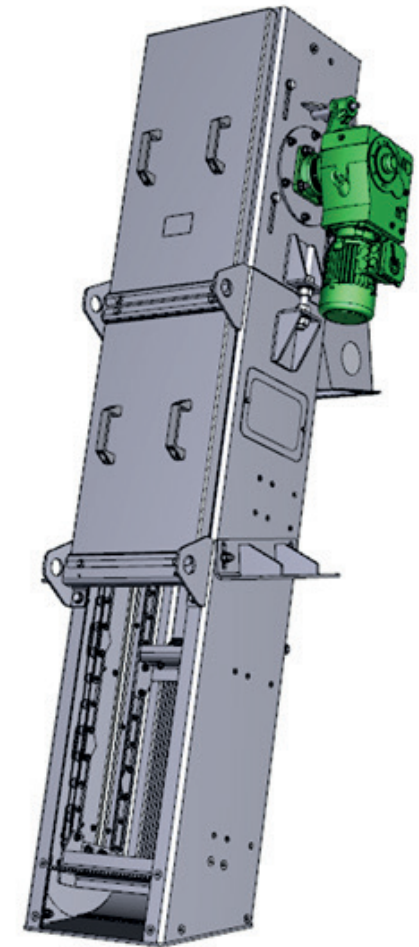

FRAME

The structure of the screen is made up of two lateral frame structures fitting the required channel width. For channel installation, lateral rubber bands are sealing the gap between screen and civil-work. Envirorak screens are covering configurations up to 2 meter width and up to 10 meters discharge height.

FILTRATION SCREEN

The screen consists of fixed bars or Johnson profil whose space between them defines the screening mesh. This model with multiple rakes is particularly adapted for high loaded effluent and can be used either as a fine or coarse screen (3 to 60 mm bar spacing).

MECANISM

Rakes are fixed to lateral chains driven by toothed wheels. The precision of the upward movement of the rakes along the bar screen and then along the sliding plate guarantees a perfect scraping and raising of waste up to the point of discharge.

WASTE

The screening waste can thus be unloaded in a container. They can be also transferred to a conveyor or a transversal screw compactor integrated to the unit (Version RKS/P).

MATERIAL

Construction in stainless steel 304L or 316L

PERFORMANCES

Mesh (mm)	Hydraulic flow rates with urban effluent (m³/h)					
	RKS 500	RKS 750	RKS 1000	RKS 1250	RKS 1500	RKS 1750
From 3 (or 6 with option) to 60 mm	Flow rates are depending of channel width, mesh and hydraulic profile (Flow velocity)					
	Up to 7500 m³/h					



implementation Aurillac

LAY-OUTS

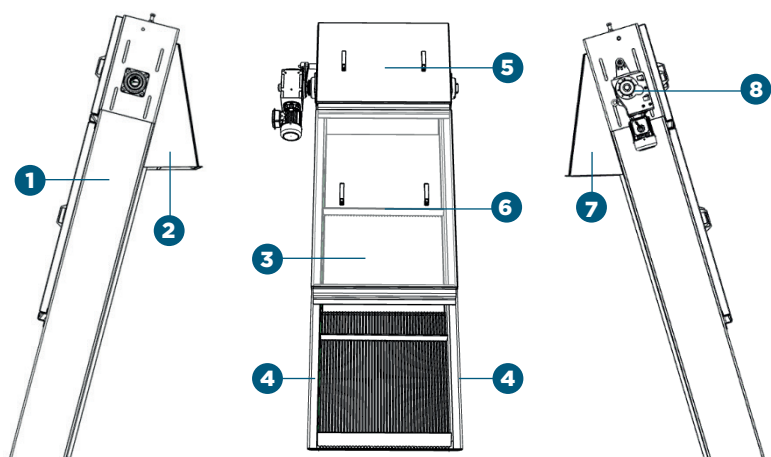

- 1 Frame
- 2 Inspection cover
- 3 Sliding plate
- 4 Lateral rake driving chains
- 5 Covers
- 6 Rake
- 7 Solid waste outlet
- 8 Motorisation

WITH SCREW COMPACTOR

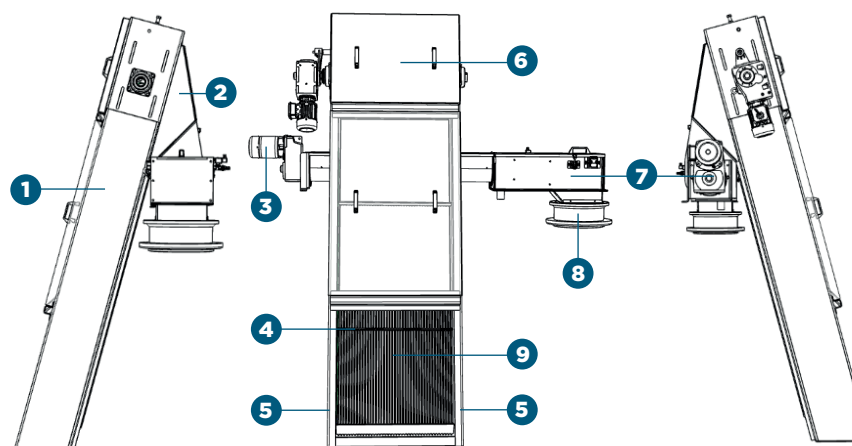

- 1 Frame
- 2 Inspection cover
- 3 Motorisations
- 4 Rake
- 5 Lateral rake driving chains
- 6 Covers
- 7 Screw compactor
- 8 Bagging unit
- 9 Bar screen

OPTION : BAR SCREEN WITH AN INTEGRATED COMPACTOR

The screening waste is falling down directly into an integrated screw compactor installed transversally where it is compressed and dewatered. Screenings can also be conditioned into a continuous plastic bagging unit before being dumped into a container.

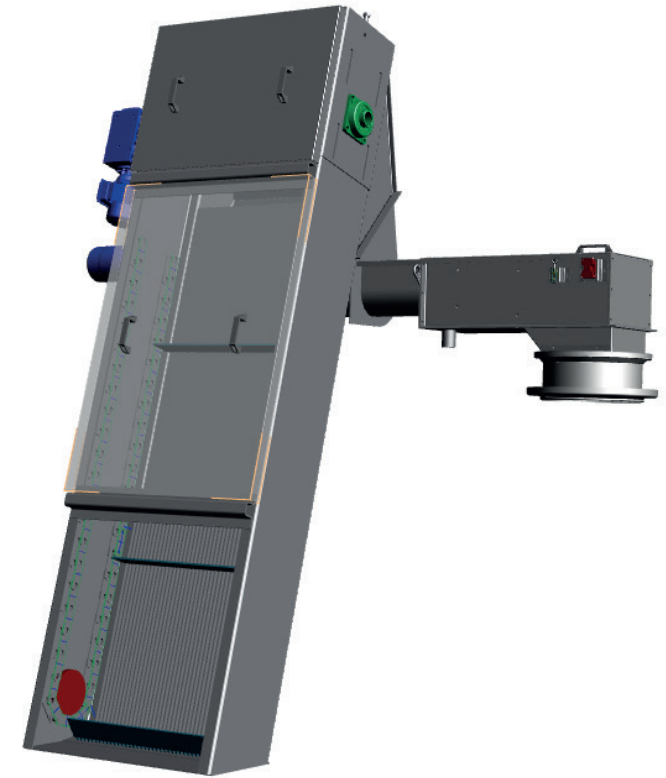

DIMENSIONS

	Overall dimensions in mm						
Models	Discharge height maxi	Total height	Channel width mini	Screen width	MKS width		Channel hold length maxi
						with compactor	
MKS 500 P	8 000	9150	500	370	0	2500	800
MKS 750 P	8 000	9150	750	620	0	2750	800
MKS 1000 P	8 000	9150	1000	860	0	3 000	800
MKS 1250 P	8 000	9150	1250	1110	0	3 250	800
MKS 1500 P	8 000	9150	1500	1360	0	3 500	800
MKS 1750 P	8 000	9150	1750	1610	1730	3 750	800

A STEP AHEAD IN WATER TECHNOLOGY

sfa-enviro.com

 [@sfa_enviro](https://twitter.com/sfa_enviro)

